

Tightening torques

Threaded connection		Torque
Bolts, nuts	M6	10 Nm
	M8	20 Nm
	M6	45 Nm
	M6	60 Nm
Deviations		
Front exhaust pipe to exhaust turbocharger		25 Nm

Engine and transmission mountings, aligning

Caution!

The assembly must be supported with the support device 10-222A before loosening the bolts.

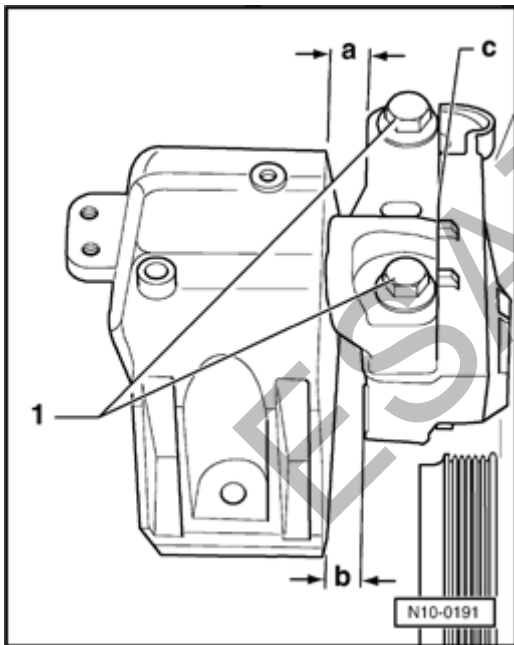

Engine assembly mounting

a = 14.0 mm

b = At least 10.0 mm

Both bolt heads - 1 - must be in flush with edge - c - .

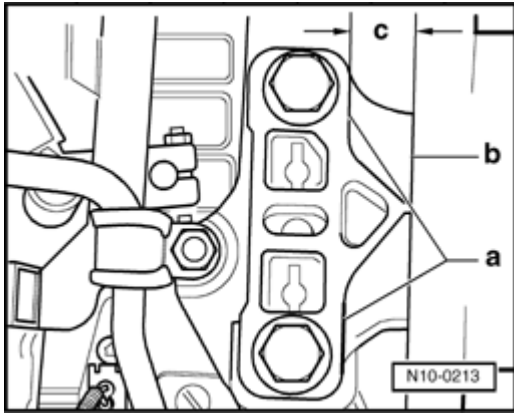

Transmission assembly mounting

The edges - **a** - and - **b** - must be parallel with one another.

c = 18...20 mm

Assembly mountings

Tightening torques

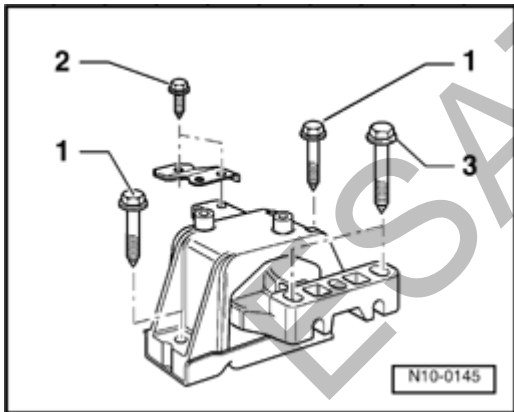

Assembly mounting, right:

- | | |
|------------------------------------|----------------------------------|
| 1 - Mounting to body ¹⁾ | 40 Nm + 90 ° (1 4 turn) further |
| 2 - Mounting/bracket to body | 25 Nm |
| 3 - Mounting to engine bracket | 100 Nm |

¹⁾ Replace bolts

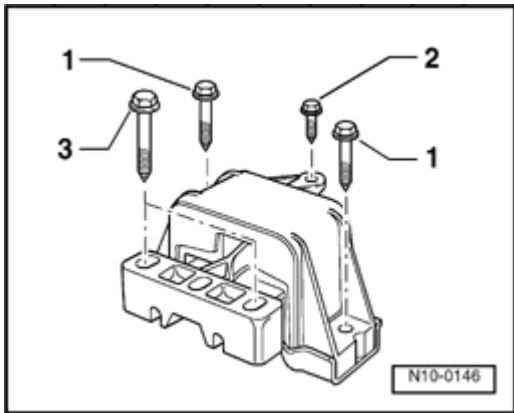

Assembly mounting, left on vehicles with manual transmission:

- | | |
|--------------------------------------|----------------------------------|
| 1 - Mounting to body ¹⁾ | 40 Nm + 90 ° (1 4 turn) further |
| 2 - Mounting to body | 25 Nm |
| 3 - Mounting to transmission console | 100 Nm |

1) Replace bolts

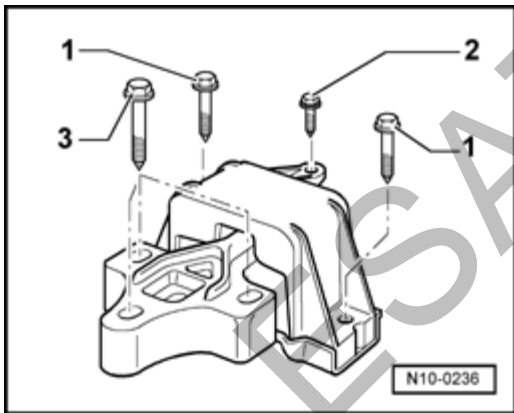

Assembly mounting, left on vehicles with automatic transmission:

- | | |
|--------------------------------------|----------------------------------|
| 1 - Mounting to body ¹⁾ | 40 Nm + 90 ° (1 4 turn) further |
| 2 - Mounting to body | 25 Nm |
| 3 - Mounting to transmission console | 100 Nm |

1) Replace bolts

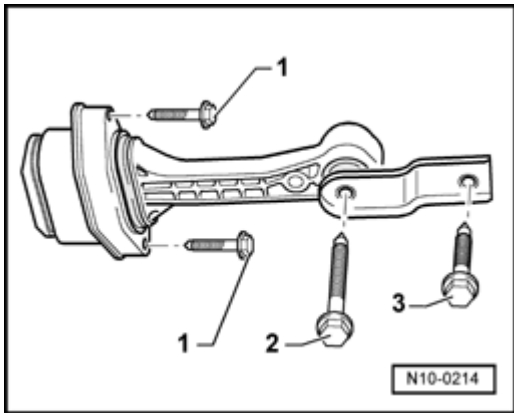

Pendulum support

Assembly order:

- | | |
|--|--------------------------------|
| 1 - Pendulum support to subframe ¹⁾ | 20 Nm + 90° (1.4 turn) further |
| 2 - Pendulum support to transmission ¹⁾ | 40 Nm +45° (1.8 turn) further |
| 3 - Pendulum support to transmission ¹⁾ | 40 Nm +45° (1.8 turn) further |

¹⁾ Replace bolts

Additional information and removal work on vehicles with air conditioning

Caution!

The air conditioning system refrigerant circuit must not be opened.

Note: ■ To prevent damage to the condenser and to the refrigerant lines, ensure that the lines and hoses are not stretched, kinked or bent.

To facilitate removing and installing the engine without opening the refrigerant circuit:

Remove retaining clamp(s) from refrigerant lines.

Remove poly V-belt NOTE: Ensure correct direction

Remove air conditioning compressor:

Read the: *Repair Manual, Heating Air Conditioning, Repair Group 87, Removing and installing compressor bracket*

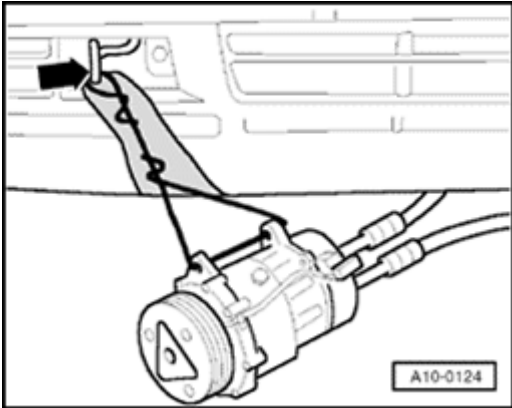

Secure the air conditioning compressor to the towing eye so that both refrigerant lines are not under tension.

Note: ■ *Prevent damage to the bumper by protecting it with tape and a protective covering.*